

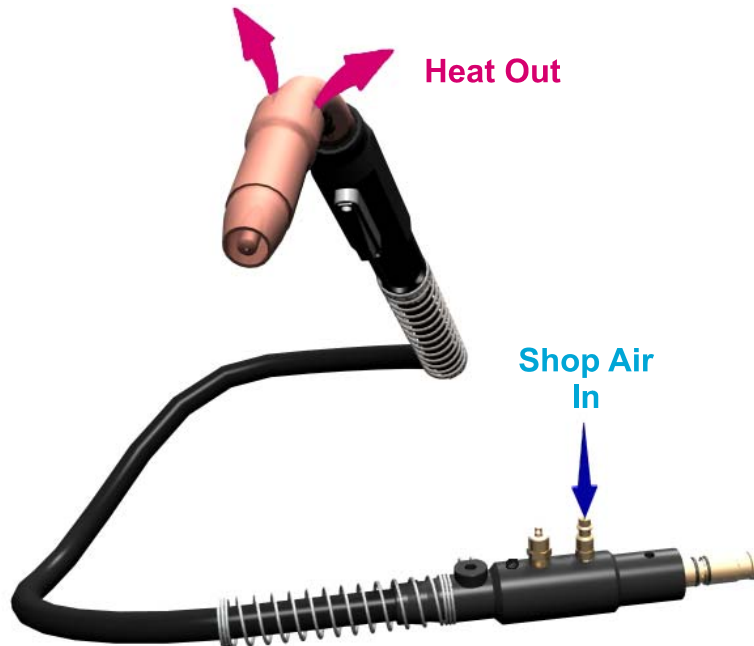

SEMI-AUTOMATIC PRESSURIZED AIR-COOLED MIG GUNS



400 & 600 Amp Models
100% Duty Cycle With Any Gas
COOL UNDER PRESSURE
THE PAC-MIG ADVANAGE™

PAC-MIG Inc.
P.O. Box 2174
Wichita, KS 67201

www.pacmig.com
E-Mail: sales@pacmig.com

Phone: 316-269-3040
Fax: 316-269-2404
Toll Free: 800-556-3040



PRESSURIZED AIR-COOLED SEMI-AUTOMATIC MIG GUN FEATURES

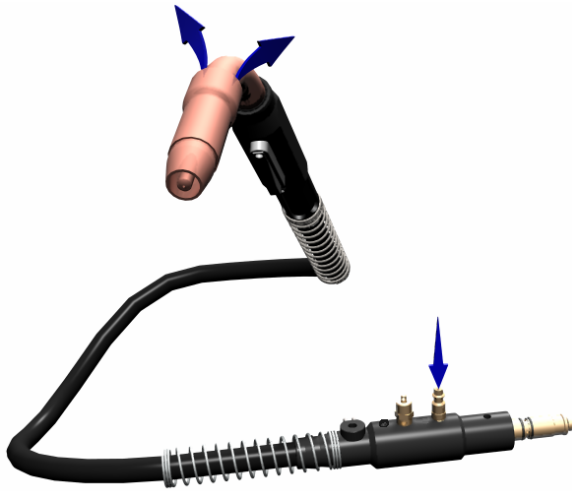

- Patented design.
- Available in 400 and 650 amp models.
- Wire sizes from .035" (.9mm) to 3/32" (2.4mm)
- Utilizes all 40 and 65 series PacMig Robotic Mig Gun consumable parts.
- Cooled with shop air (1.2 – 1.8 CFM) from the rear case to the shrouded nozzle.
- Replaces water-cooled or hot running standard air-cooled guns.
- Eliminates "Hot Hand"
- 100% duty cycle with any gas.
- Quick-change conductor tubes can be rotated 360 degrees.
- PAC-MIG guns will not be destroyed due to lack of, or no air flow.
- Minimal maintenance is required.
- Modular design makes repairs easy.
- Front end consumable life is increased by a minimum of 20%.
- Specials available on request.

Ordering Instructions

400 Amp	600Amp
PX-4010-XXXX	PX-6510-XXXX
PX-4012-XXXX	PX-6512-XXXX
PX-4015-XXXX	PX-6515-XXXX
PX-4020-XXXX	PX-6520-XXXX
PX-4025-XXXX	PX-6525-XXXX

When ordering Mig Guns replace the (X) in the above listing with the appropriate letter or number from the options below.

Part No. Exclamation:

<p>PX4010-XXXX</p> <p>Torch Type ———</p> <p>Rear Connection ———</p> <p>Amps ———</p> <p>Wire Size ———</p> <p>Cable Length ———</p>	<p>Example: PT-4010-0116</p> <p>Pressurized Air-Cooled Semi-Automatic Mig Gun</p> <p>Tweco rear connection plug</p> <p>400 amp</p> <p>10 ft cable</p> <p>1/16 wire conduit & tip</p>
--	---

	Options	
Mig Gun Type	P = Econo-Mig Semi-Automatic Ambient Air Cooled	
Rear Connector Plug	T = Tweco M = Miller L = Lincoln	P = Panasonic E = Euro
Amp	400 & 600	
Cable Length	10', 12', 15', 20', & 25'	
Wire Size	.035", .040", .045", .052", 1/16", & 3/32"	
Additional Options:		
<ul style="list-style-type: none"> • Custom lengths available on request. • Dual Schedule Trigger 	<ul style="list-style-type: none"> • Locking Trigger • Kevlar Cable Cover • Custom Conductor Tubes 	

Consumable Options for Pressurized Air-Cooled 400 & 650 Amp Semi-Automatic Mig Guns

400 Amp					
Wire Size	Contact Tip Standard	Contact Tip Tapered	Gas Diffuser	Conduit Liner (Steel Wire)	Nylon Conduit Liner (Aluminum Wire)
.030/.8mm	TT-30	TT-30T	TD45	P44-3545-15 P44-3545-25	P44N-3545-15
.035/.9mm	TT-35	TT-35T			
.040/1.0mm	TT-40	TT-40T			
.045/1.2mm	TT-45	TT-45T			
3/64/1.2mm(Al)	TT-364	TT-364T		N/A	P44N-116-15
.052/1.3mm	TT-52	TT-52T		P44-116-15 P44-116-25	P44N-116-15 P44N-116-25
1/16/1.6mm	TT-116	TT-116T		P44-564-15 P44-564-25	N/A
5/64/2.0mm	TT-564	TT-564T			

650 Amp					
Wire Size	Contact Tip Standard	Contact Tip Tapered	Gas Diffuser	Conduit Liner (Steel Wire)	Nylon Conduit Liner (Aluminum Wire)
.030/.8mm	TT-30	TT-30T	TD-65-SW	C6-3545-15 C6-3545-25	C6N-3545-15 C6N-3545-25
.035/.9mm	TT-35	TT-35T			
.040/1.0mm	TT-40	TT-40T			
.045/1.2mm	TT-45	TT-45T			
3/64/1.2mm(Al)	TT-364	TT-364T		N/A	C6N-116-15 C6N-116-25
.052/1.3mm	TT-52	TT-52T		C6-116-15 C6-116-25	C6N-116-15 C6N-116-25
1/16/1.6mm	TT-116	TT-116T	TD65-H	C6-564-15 C6-564-25	N/A
5/64/2.0mm	TT-564	TT-564T		C6-332-15 C6-332-25	N/A
3/32/2.4mm	TT-332	TT-332T			

Nozzles for 400 Amp Pressurized Air-Cooled Semi-Automatic Mig Guns Package of 5 ea.

Standard Part No.	Heavy Duty Part No.	Description
PN40-50	HPN40-50	400 Amp Nozzle 1/2" w/5/32 recess
PN40-50F	HPN40-50F	400 Amp Nozzle 1/2" Flush
PN40-50-P	HPN40-50-P	400 Amp Nozzle 1/2" w/1/8 Projection
PN40-62	HPN40-62	400 Amp Nozzle 5/8" w5/32 Recess
PN40-62F	HPN40-62F	400 Amp Nozzle 5/8" Flush
PN40-62-P	HPN40-62-P	400 Amp Nozzle 5/8" w/1/8" projection
PN40-75	N/A	400 Amp Nozzle 3/4" w5/32 Recess
PN40-75F	N/A	400 Amp Nozzle 3/4" Flush
PN40-75-P	N/A	400 Amp Nozzle 3/4" w/1/8" projection

Nozzles for 650 Amp Pressurized Air-Cooled Semi-Automatic Mig Guns Package of 5 ea.

Standard Part No.	Heavy Duty Part No.	Description
PN65-50	N/A	650 Amp Nozzle 1/2" w/5/32 recess
PN65-50F	N/A	650 Amp Nozzle 1/2" Flush
PN65-50-MS	N/A	650 Amp Nozzle 1/2" Mini Shroud w/5/32 recess
PN65-50F-MS	N/A	650 Amp Nozzle 1/2" Flush Mini Shroud
PN65-50-P	N/A	650 Amp Nozzle 1/2" w/1/8 Projection
PN65-50P-MS	N/A	650 Amp Nozzle 1/2" Mini Shroud w/1/8 Projection
PN65-62	HPN65-62	650 Amp Nozzle 5/8" w/5/32 recess
PN65-62F	HPN65-62F	650 Amp Nozzle 5/8" Flush
PN65-62-MS	HPN65-62-MS	650 Amp Nozzle 5/8" Mini Shroud w/5/32 recess
PN65-62F-MS	HPN65-62F-MS	650 Amp Nozzle 5/8" Flush Mini Shroud
PN65-62-P	HPN65-62-P	650 Amp Nozzle 5/8" w/1/8 Projection

Nozzles for 650 Amp Pressurized Air-Cooled Semi-Automatic Mig Guns (Continued)

Standard Part No.	Heavy Duty Part No.	Description
PN65-62P-MS	HPN65-62P-MS	650 Amp Nozzle 5/8" Mini Shroud w/1/8 Projection
PN65-75	HPN65-75	650 Amp Nozzle 3/4" w/5/32 recess
PN65-75F	HPN65-75F	650 Amp Nozzle 3/4" Flush
PN65-75-P	HPN65-75P	650 Amp Nozzle 3/4" w/1/8 Projection
PN65-75-MS	N/A	650 Amp Nozzle 3/4" Flush Mini Shroud
PN65-75F-MS	N/A	650 Amp Nozzle 3/4" Mini Shroud w/5/32 recess
PN65-75P-MS	N/A	650 Amp Nozzle 3/4" Mini Shroud w/1/8 Projection
N/A	HPN65-75LS	650 Amp Nozzle 3/4" Long Shroud w/5/32 recess
N/A	HPN65-75LSF	650 Amp Nozzle 3/4" Flush Long Shroud
N/A	HPN65-75LS-P	650 Amp Nozzle 3/4" Long Shroud w/1/8 Projection

Replacement Conductor Tubes

400 Amp	
Part No.	Description
CT40-45-3R-A	45 Deg. Bend 3" Radius
CT40-60-3R-A	60 Deg. Bend (Std.) 3" Radius
CT40-80-3R-A	80 Deg. Bend 3" Radius
CT40-180-A	180 Deg. Short Straight
CT40-45-5R-A	45 Deg. Bend 5" Radius
CT40-60-5R-A	60 Deg. Bend (Std.) 5" Radius
CT40-80-5R-A	80 Deg. Bend 5" Radius
CT40-180L-A	180 Deg. Long Straight

650 Amp	
Part No.	Description
CT65-45-3R-A	45 Deg. Bend 3" Radius
CT65-60-3R-A	60 Deg. Bend (Std.) 3" Radius
CT65-80-3R-A	80 Deg. Bend 3" Radius
CT65-180-A	180 Deg. Short Straight
CT65-45-5R-A	45 Deg. Bend 5" Radius
CT65-60-5R-A	60 Deg. Bend (Std.) 5" Radius
CT65-80-5R-A	80 Deg. Bend 5" Radius
CT65-180L-A	180 Deg. Long Straight

Replacement Parts

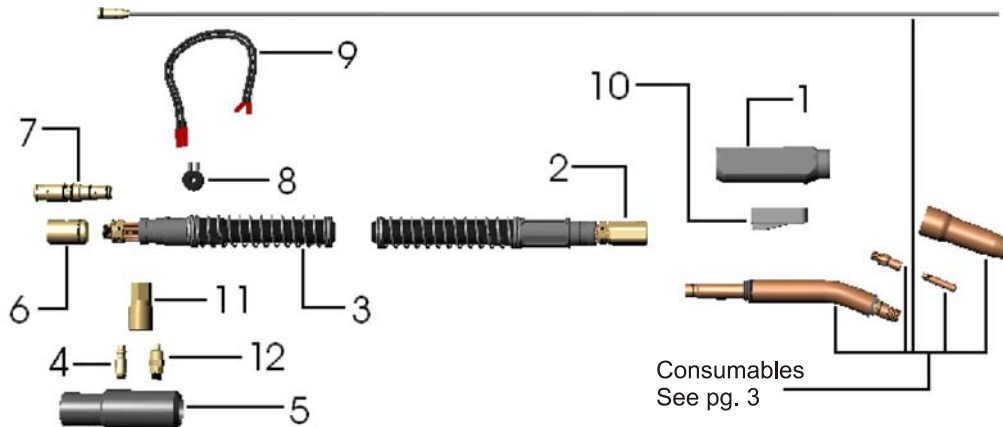

Item No.	Part No.	Description	Item No.	Part No.	Description
1	H-46-A	Handle Assy.	7	CP-4L-A	Lincoln Connector Plug 400 amp
2	FCB-46A	Front Connector Block Assy. 650 amp		CP-6L-A	Lincoln Connector Plug 650 amp
	FCB-40-A	Front Connector Block Assy. 400 amp		CP-46P-A	Panasonic Connector Plug 400/650 amp
3	CHA46-X	Semi-Automatic Cable Hose Assy.		CP-124X-A	Euro Connector Plug 400/650 amp
4	AIF	Air Intake Fitting	8	TLWB-A	Trigger Lead Wire Button Assy.
5	RCR-46-A	Rear Case Assy.	9	TLC-A	Trigger Lead Wire Adapter
6	RCBR-46-A	Rear Connector Block Assy.	10	T-1	Trigger
7	CP-4T-A	Tweco Connector Plug 400 amp	11	AQC	Air Quick Coupler
	CP-6T-A	Tweco Connector Plug 650 amp	12	PV-1	Pressure Relief Valve
	CP-4M-A	Miller Connector Plug 400 amp		N/S	R-Kit
	CP-6M-A	Miller Connector Plug 650 amp			

PAC-MIG Inc.
 311 Laura
 Wichita Ks. 67211
 316-269-3040
 316-269-2404 (Fax)
www.pacmig.com
 E-Mail: sales@pacmig.com